

TIMKEN 240RU91参数

轴承型号	Part Number	240RU91		-
	Subtype	NU		-
尺寸	d	240	mm	内径
	D	389.999	mm	外径
	B	108.001	mm	宽度
额定载荷	C1	1801530	N	一百万转动态径向载荷
	C0	2646692	N	静态额定载荷
几何结构系数	Cg	0.2551		几何系数
极限转速	oil	1900		润滑油
	grease	1500		润滑脂
尺寸	R	2.54	mm	最大轴肩倒角半径
	da	264.922	mm	轴肩直径
	r	2.54	mm	最大轴承座挡肩圆角半径
	Da	364.998	mm	轴承座挡肩直径
重量	Assembly Weight	53387.82	g	-

TIMKEN 240RU91图片

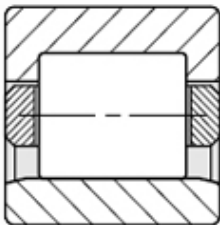
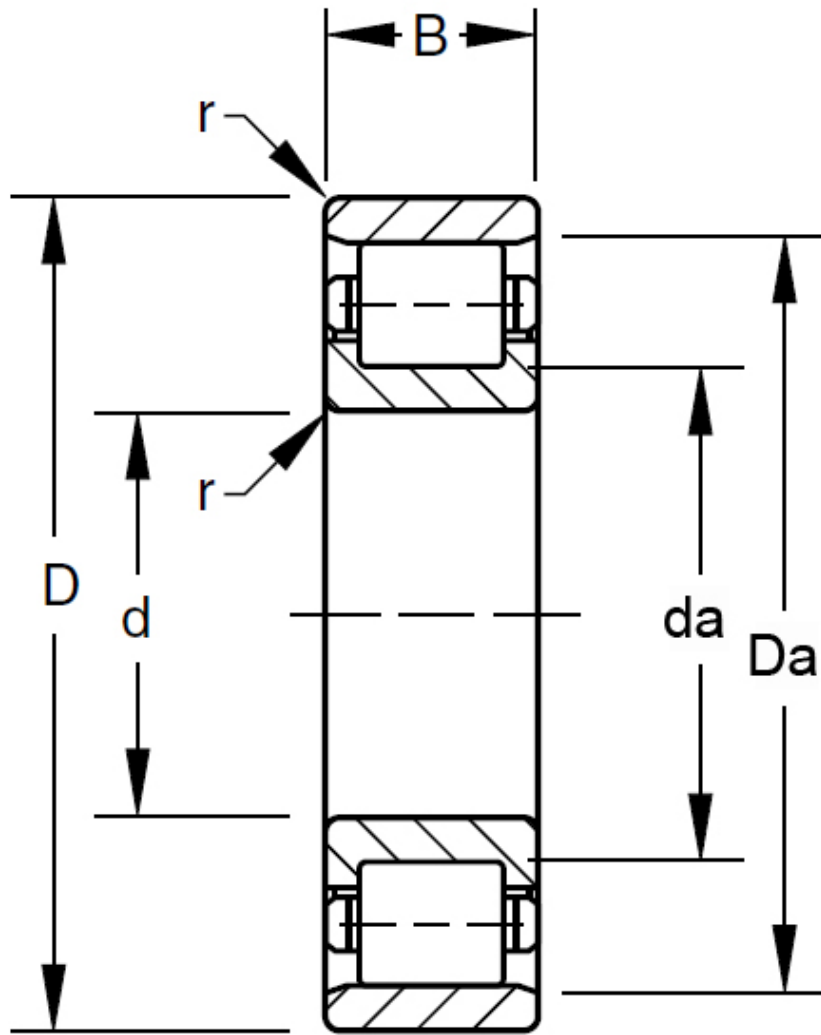

RU
RIU

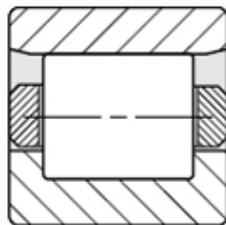

RN
RIN

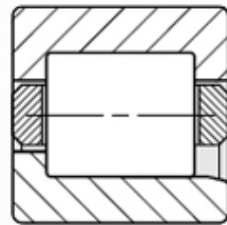

RJ
RIJ

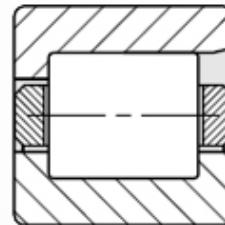

RF
RIF

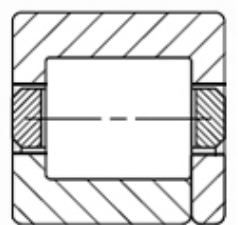

RT
RIT

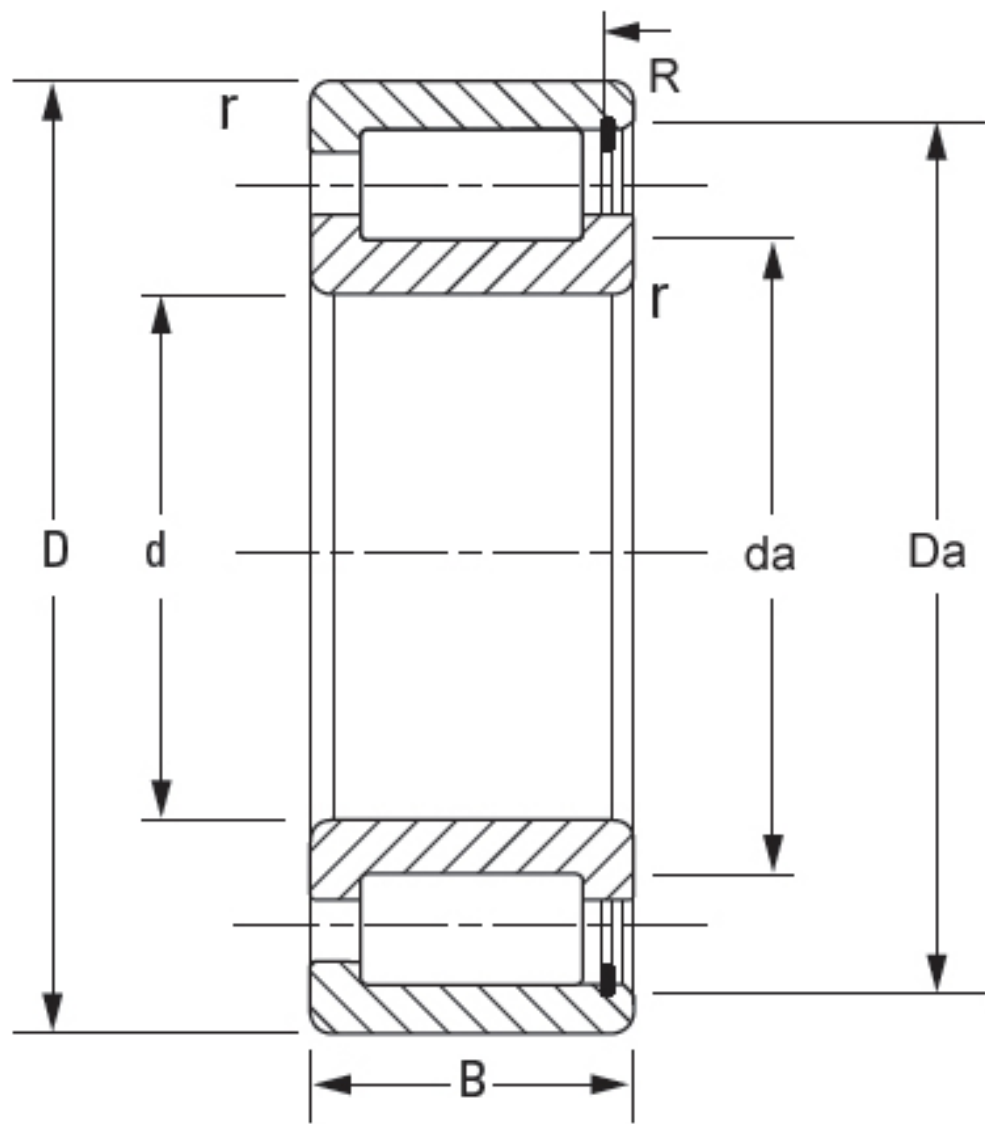

NCF