

SKF GE 100 TXG3A-2LS参数

主要尺寸	d	100	mm	-
	D	150	mm	-
	B	70	mm	-
	C	55	mm	-
倾斜角	±	6	度	-
基本额定载荷	C	1730000	N	动载荷
	$C_0$	2850000	N	静载荷
重量	重量	4400	g	-
型号	型号	GE 100 TXG3A-2LS	-	-

SKF GE 100 TXG3A-2LS图片

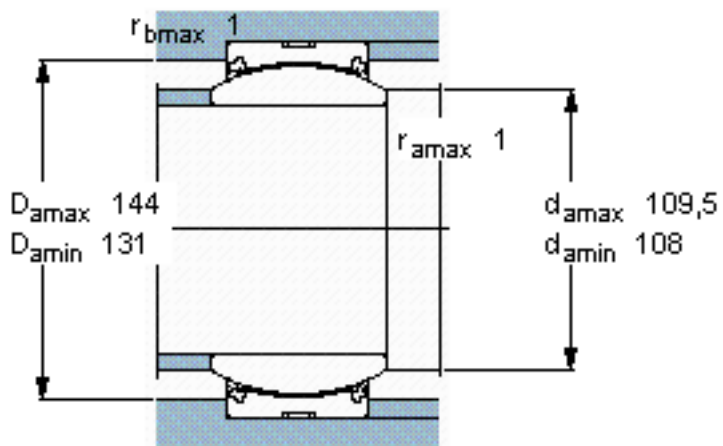
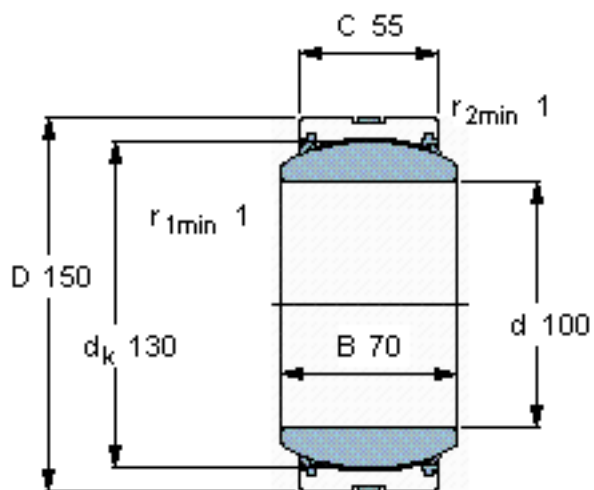

**特定负荷系数**

K 300

**材料常数**

$K_M$  770/4000/40000

参考资料:<http://www.sozhou.com/p/4c84f848.html>

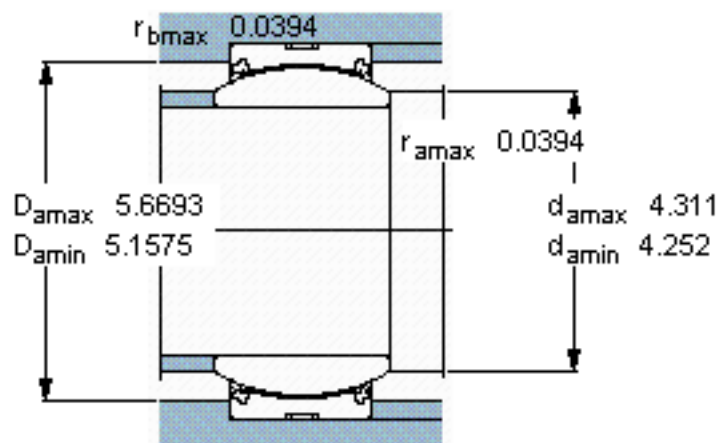
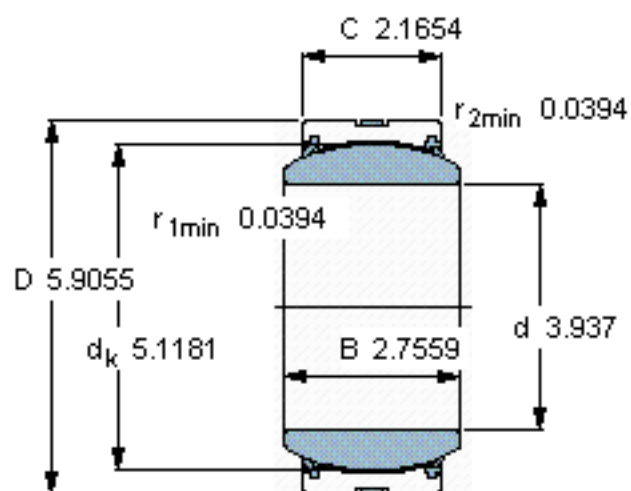

**特定负荷系数**

$K$  300

**材料常数**

$K_M$  770/4000/40000