

SKF GEH 10 C参数

主要尺寸	d	10	mm	-
	D	22	mm	-
	B	12	mm	-
	C	7	mm	-
倾斜角	±	18	度	-
基本额定载荷	C	11400	N	动载荷
	$C_0$	28500	N	静载荷
重量	重量	20	g	-
型号	型号	GEH 10 C	-	-

SKF GEH 10 C图片

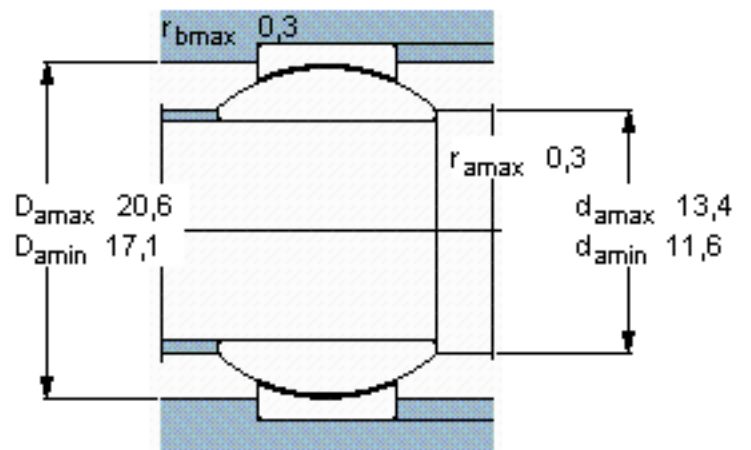
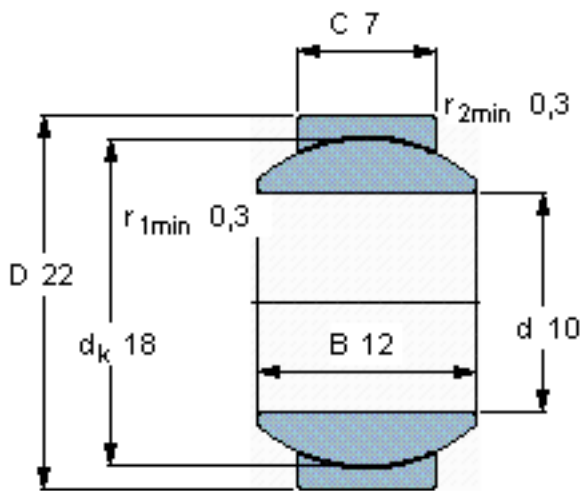

**特定负荷系数**

K 100

**材料常数**

$K_M$  1400

参考资料:<http://www.sozhou.com/p/69e708e6.html>

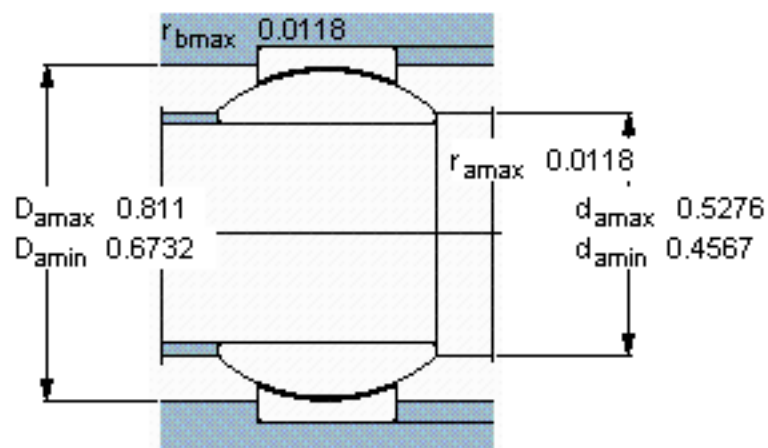
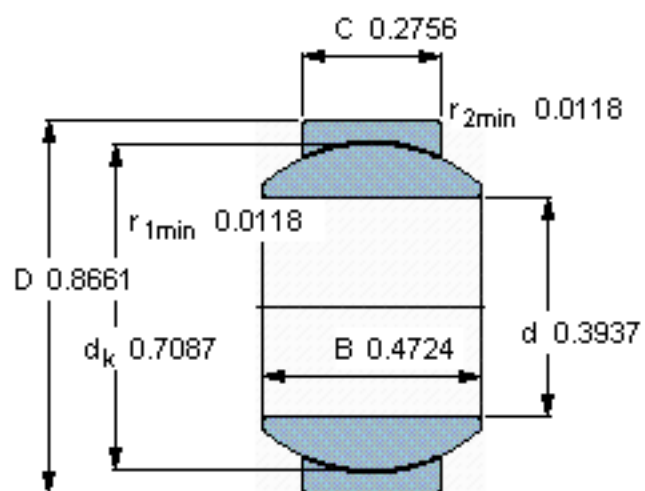

**特定负荷系数**

$K$  100

**材料常数**

$K_M$  1400