

### FAG H241/1250-HG参数

尺寸	$d_{1H}$	1180	mm	-
	$D_m$	1490	mm	-
	$l$	885	mm	-
	$c$	125	mm	-
	$c_1$	150	mm	-
	$d$	1250	mm	-
	$e$	14	mm	-
	$R_o$	G1/4		-
	$t$	15	mm	-
说明		1180	mm	轴
		HM31/1250		型号, 螺母
		MS31/1000		型号, 止动装置
		M24X45		型号, 六角头螺栓
重量	$m$	1540000	g	质量
尺寸	$d_{2G}$	Tr1250x8	mm	-

### FAG H241/1250-HG图片

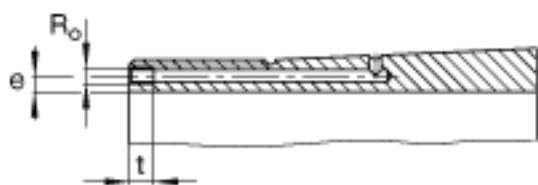

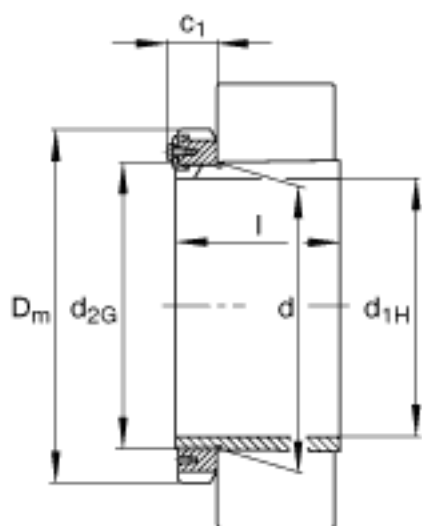

参考资料:<http://www.sozhou.com/p/9abb9e18.html>