

## TIMKEN NCF1852V参数

轴承型号	Part Number	NCF1852V		-
	Subtype	NCF		-
尺寸	d	259.999	mm	内径
	D	319.999	mm	外径
	B	28.001	mm	宽度
额定载荷	C1	296696	N	一百万转动态径向载荷
	C0	560476	N	静态额定载荷
几何结构系数	Cg	0.1377		几何系数
极限转速	oil	580		润滑油
	grease	480		润滑脂
尺寸	R	2.032	mm	最大轴肩倒角半径
	da	268.732	mm	轴肩直径
	r	2.032	mm	最大轴承座挡肩圆角半径
	Da	311.15	mm	轴承座挡肩直径
重量	Assembly Weight	4808.08	g	-

## TIMKEN NCF1852V图片

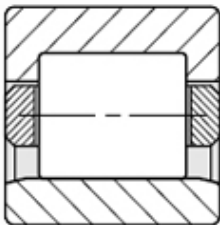
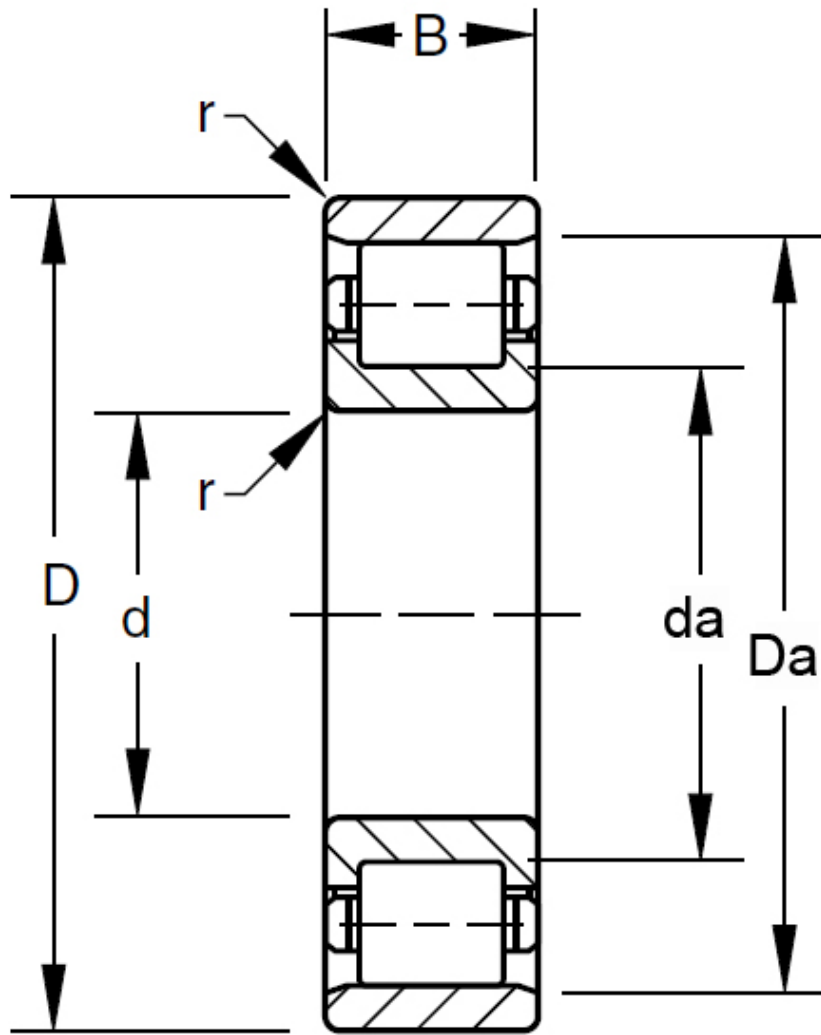

RU  
RIU

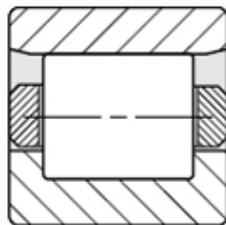

RN  
RIN

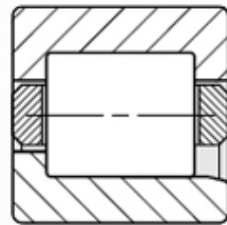

RJ  
RIJ

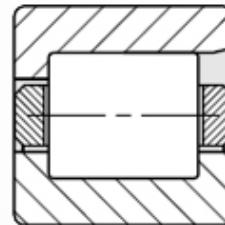

RF  
RIF

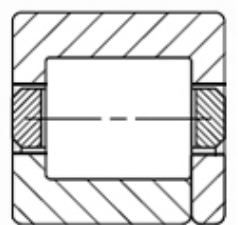

RT  
RIT

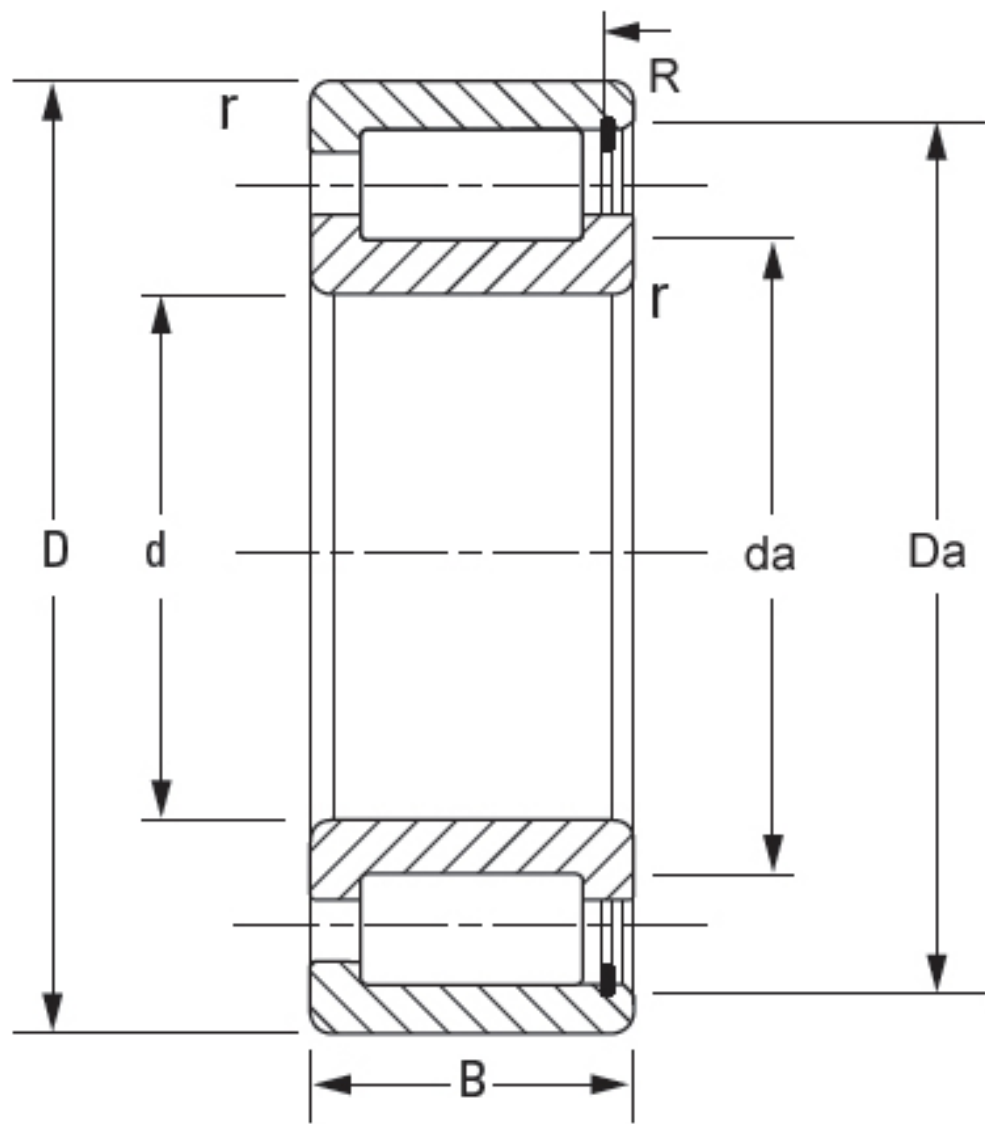

**NCF**